

CIVCO Technical Data Sheet

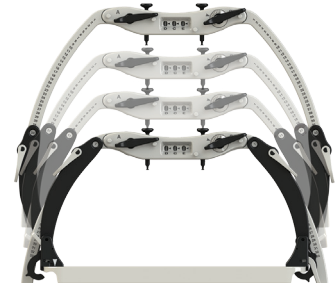

Product Name	Body Pro-Lok ONEBridge™			
Product Number	BPL001			
Kits that include this product	BPL100 BPL200	BPL110 BPL210	BPLONEUPG BPL220	BPLONEUPG2 & 3 BPL230
General Description	An integral part of the Body Pro-Lok ONE System, the ONEBridge is designed to take the role of our previous 3 bridges. Its unique design allows for a full range of height adjustments, while expanding or constricting its contour based on height. It has a UCT docking profile, and features lateral and tilting adjustments. The ONEBridge accepts the Standard Respiratory Plate and Clam-Lok™ cushion.			
Indications for use	SBRT Patient Immobilization			
Contraindications	None			
MRI Compatible	Body Pro-Lok ONEBridge & ONEPlatform™ are MR Safe			
Integration	Connects natively to Universal Couchtop™ & ONEPlatform. When using Body Pro-Lok evo Adapter connects to iBEAM® evo Couchtops.			
FDA Clearance	Yes			
CE Marked (EU DOC)	Yes			
Other Country Registrations	Available upon request			

Technical Details

Primary Materials	Acetal (Black & Cream), Kevlar (Platform)
Weight (approx)	2.04 kg / 4.5 lbs (Bridge), 6.6 kg / 14.5 lbs (Platform)
Dimensions (mm)	620 L x 119 W x 320 H (min.)

Technical Drawing

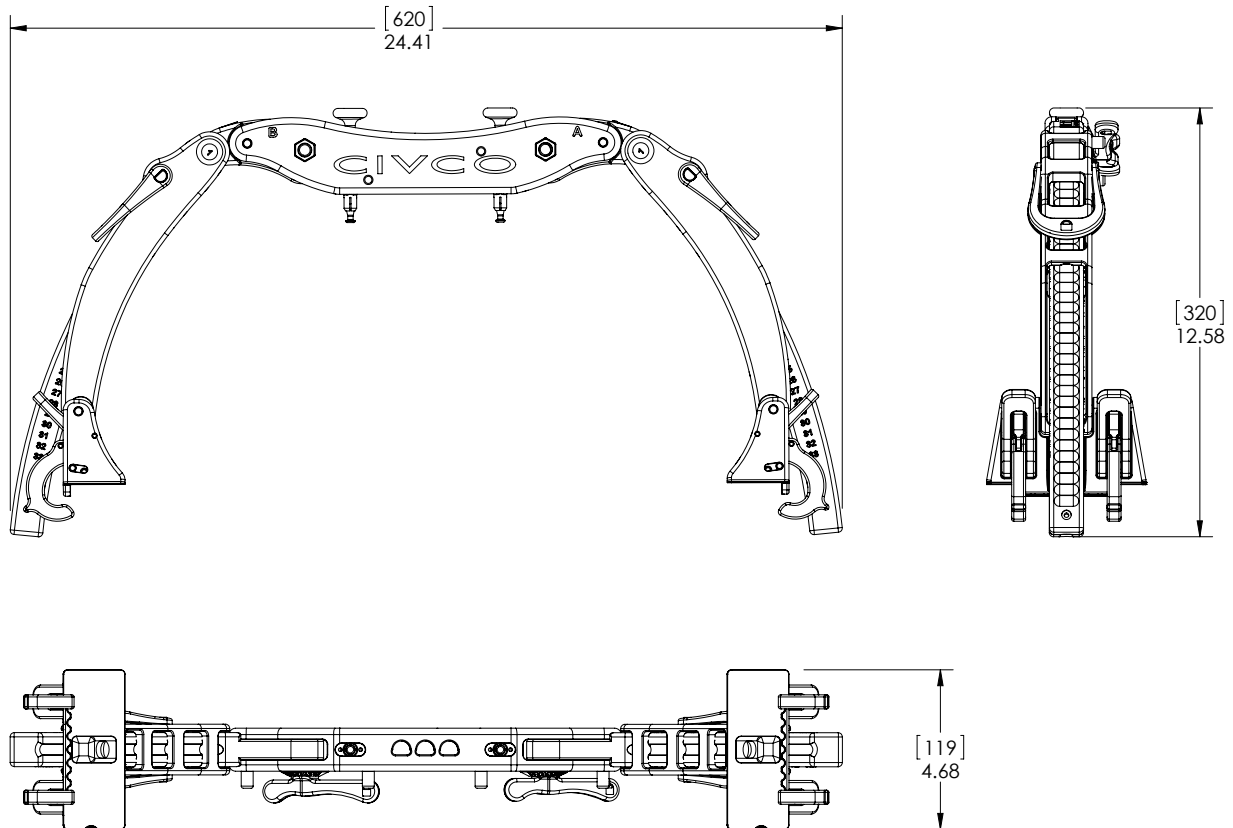

Country of Manufacture	USA
-------------------------------	-----

Packaging

Unit Pack	1 Piece
Units / Box	1 Piece
Shelf Life	Not Applicable
Warranty	See CIVCO website for Product Warranty Statement
Sterilization	Non-Sterile
Launch Date	September 2014

Accessories

System Customization	Standard Respiratory Plate: MTSBRT003 Body Pro-Lok ONE™ Respiratory Belt: BPL002 ONEBridge™: BPL001 Patient Handle, right: MTIL662501 Patient Handle, left: MTIL662502 Shoulder Restraint Bridge 2: MTSBRT038 Forehead Restraint: MTSBRT018 Clam-Lok™ Cushion: MTSBRT202 T-Shape Vac-Lok™ Cushion: MTVL0017 Monarch Overhead Arm Positioner: OPA110 Extended Wing Board w/ T-Grip: MTWB08T Extended Wing Board w/U-Grip: MTWB08U 3-Pin Lok-Bar™, Prodigy 2, 53 cm: MTIL6054 Slide Guide Lok-Bar: MTVL00853 Transverse Lok-Bar, Prodigy 2, 53 cm: MTIL6051 Kneefix™ 3 Cushion: 301052 Feetfix™ 3 Cushion: 301071 ONEBridge Storage Base: BPL005 Body Pro-Lok ONE evo Adapter: BPL010
-----------------------------	---

Global Sales Office
Orange City, Iowa, USA
800.842.8688 | +1.712.737.8688

info@civco.com
www.civco.com

